

**GRIFCO**<sup>®</sup>  
POWERING COMMERCIAL DOORS

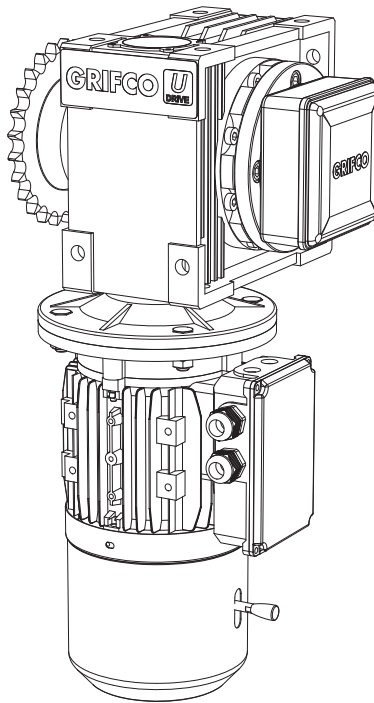

# INSTRUCTION MANUAL



## **U-Drive Operator for Non Spring-Balanced Roller Shutters**

THIS OPERATOR IS TO BE INSTALLED AND SERVICED BY A TRAINED TECHNICIAN ONLY  
Compatible with GLMe2 eDrive +2.0 Wall Control

Chamberlain Australia Pty Ltd  
PO Box 1446, Lane Cove  
NSW 1595, Australia  
Phone toll free 1800 474 326

Chamberlain New Zealand Ltd  
PO Box 100-221  
North Shore 0745, New Zealand  
Phone toll free 0800 653 667

[www.grifco.com.au](http://www.grifco.com.au)  
[www.grifco.co.nz](http://www.grifco.co.nz)

This commercial door operator has been designed and tested to offer safe service provided it is installed, operated, maintained and tested in strict accordance with the instructions and warnings contained in this manual.

 **WARNING**

Mechanical

 **WARNING**

Electrical

**CAUTION**

When you see these Safety Symbols and Signal Words on the following pages, they will alert you to the possibility of serious injury or death if you do not comply with the warnings that accompany them. The hazard may come from something mechanical or from electric shock.

When you see this Signal Word on the following pages, it will alert you to the possibility of damage to your commercial door and/or the commercial door operator if you do not comply with the cautionary statements that accompany it.

**THESE ARE IMPORTANT SAFETY INSTRUCTIONS. FOLLOW ALL INSTRUCTIONS AS INCORRECT**

**INSTALLATION CAN LEAD TO SEVERE INJURY OR DEATH**



Keep commercial door maintained. Sticking or binding doors must be repaired. Commercial doors, brackets and their hardware are under extreme tension and can cause serious personal injury. Do not attempt to loosen, move or adjust them. Call for commercial door service.



Unbalanced roller shutter doors require a Suitable Anti-Drop device to catch the door in the event of a failure of the drive system., such as the GRIFCO GSB-600.



Do not wear rings, watches or loose clothing while installing or servicing a commercial door opener.



To avoid serious personal injury from entanglement, remove all ropes connected to the commercial door before installing the door control.



Installation and wiring must be in compliance with your local building and electrical codes. Connect the power supply cord only to properly earthed mains if applicable.



Moisture and water can destroy the electronic components. Make sure under all circumstances that water moisture or storage moisture cannot penetrate the electronics. The same applies for openings and cable entries.



After the installation a final test of the full function of the system and the full function of the safety devices must be done.



When operating a biased-off switch, make sure that other persons are kept away.



The opener cannot be used with a driven part incorporating a wicket door (unless the opener cannot be operated with the wicket door open).



Motor may become hot during operation. Appropriate clearance and/or shielding should be supplied by the installer to ensure any cabling, wiring and/or other items cannot come in contact with the motor. If temperature rise exceeds 50°C all fixed wiring insulation must be protected, for example, by insulating sleeving having an appropriate temperature rating.



Where applicable, permanently fasten all supplied labels adjacent to the wall control as a convenient reference and reminder of safe operating procedures.



Disengage all existing commercial door locks to avoid damage to commercial door. Install the control (or any additional push buttons) in a location where the commercial door is visible during operation . Do not allow children to operate push button(s) or remote control(s). Serious personal injury from a closing commercial door may result from misuse of the opener.



Activate opener only when the door is in full view, free of obstructions and opener is properly adjusted. No one should enter or leave the building while the door is in motion.



An electrician must disconnect electric power to the commercial door opener and control before making repairs or removing covers.



The actuating member of a biased-off switch is to be located within direct sight of the door but away from moving parts. Unless it is key operated, it is to be installed at a minimum height of 1500mm and not accessible to the public.



Make sure that people who install, maintain or operate the door follow these instructions. Keep these instructions in a safe place so that you can refer to them quickly when you need to.



This appliance is not intended for use by persons (including children) with reduced physical, sensory or mental capabilities, or lack of experience and knowledge, unless they have been given supervision or instruction concerning use of the appliance by a person responsible for their safety. Children should be supervised to ensure that they do not play with the appliance.



If the opener is installed at a height less than 2,5 meters from floor level or any other level from which the unit can be accessed (eg mezzanine) the installer is responsible to fit guards to the opener to prevent access to the chain drive.



Ensure that the temperature range marked on the operator is suitable for the location. Ensure that entrapment due to the opening movement of the of the driven part is avoided.

 **WARNING:**

**Important safety instructions  
It is important for the safety of persons to follow all instructions.  
SAVE these instructions**

# TABLE OF CONTENTS

<b>SAFETY INSTRUCTIONS .....</b>	<b>2</b>
<b>TYPICAL INSTALLATION .....</b>	<b>4</b>
<b>SPECIFICATIONS .....</b>	<b>5-9</b>
Specifications Table.....	5
Dimensions .....	6
Contents .....	7
Selection Guide .....	8-9
<b>INSTALLATION .....</b>	<b>10-17</b>
Install Wall Brackets.....	10
Install Door Drum .....	10
Install Flange Bearing .....	10
Install Safety Brake Angle.....	11
Install Safety Brake .....	11
Select Mounting Configuration.....	12
Select In-Board or Out-Board Mounting Configuration.....	13
Install Operator Mounting Plate .....	13
Mount Operator to Wall Bracket .....	14
Install Sprocket.....	14
Install Drive Chain .....	15
Electrical Installation.....	16-17
<b>COMMISSIONING .....</b>	<b>18-19</b>
Setting Limits.....	18
Manual Setting of Door Position .....	19
<b>MAINTENANCE .....</b>	<b>20</b>
<b>TROUBLESHOOTING.....</b>	<b>21-22</b>
<b>CHAMBERLAIN LIMITED WARRANTY .....</b>	<b>24</b>

The U-Drive can be operated with a standard GLMe2 Series controller, or one of our standard reversing starters. The mechanical limit system and high torque output make this an ideal solution for high-cycle non spring-balanced roller shutters and grilles.

This manual details the mechanical installation of the U-Drive system and safety brake. For all other electrical connections please refer to the respective controller's manual.

# TYPICAL INSTALLATION

INSTALLATION OF GUDK-RSO-H073M SHOWN

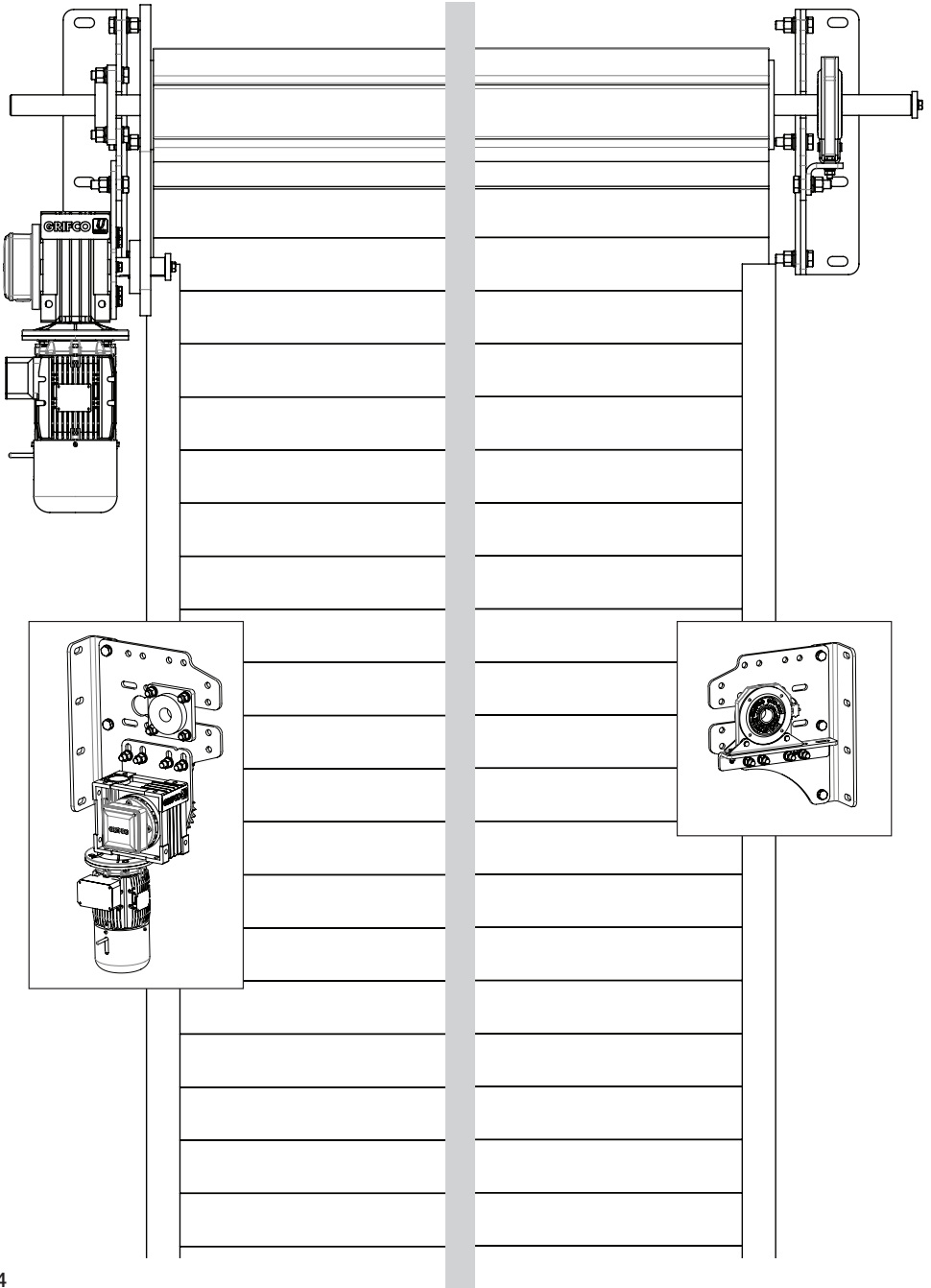

## SPECIFICATIONS

	GUD-H053M GUD-MK-05	GUD-H073M GUD-MK-07
Peak Opener Torque	180 Nm	260 Nm
Peak Drum Torque	600 Nm	600 Nm
Max Bracket capacity (Pair)	574 kg	800 Kg
Power	0.5 Hp	0.75 Hp
Full Load Current	1.8 A	2 A
Volts (AC)	415 V	415V
Phase	3	3
Max safety brake speed	16 rpm	16 rpm
Output shaft speed	14 rpm	14 rpm
Limits	2 x N/C Micro Switch	2 x N/C Micro Switch
Rated Load	110N.m @ RUN TIME = 7.6min	183N.m @ RUN TIME = 10min
Drive Sprocket supplied	25T 12B	25T 12B

\* Note: Door size indication only based on standard door weights and dimensions, it remains the responsibility of the installer to confirm maximum drum torque and system mass before installation.

# SPECIFICATIONS

## GUD-H053M / GUD-H073M

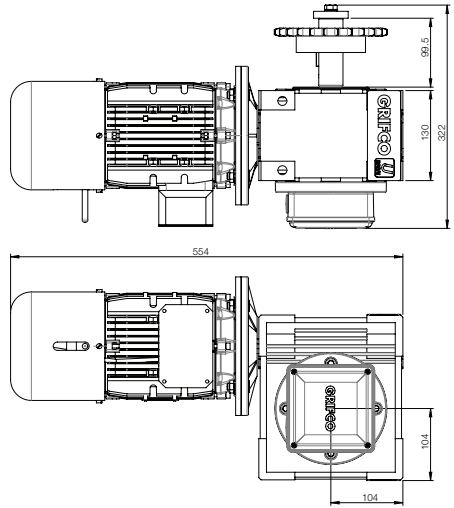
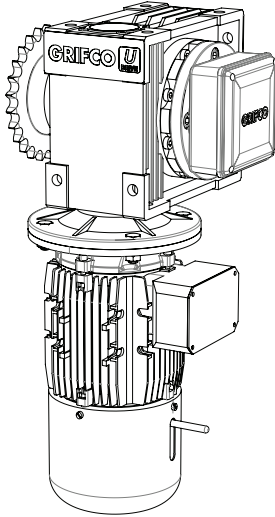

## GUD-MK-05

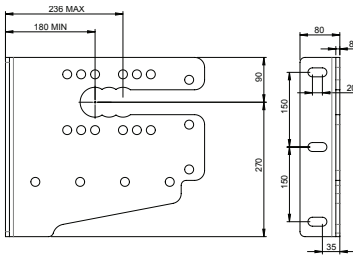

## GUD-MK-07

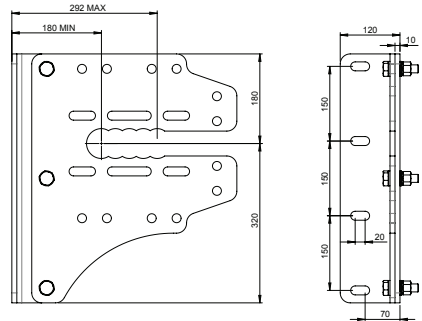

## GSB-600

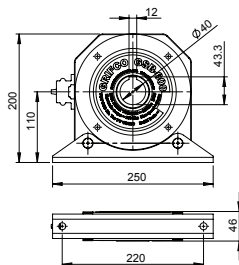

## FLANGE BEARING

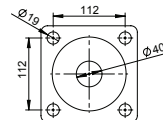

# SPECIFICATIONS

## CONTENTS

### GUDK-RSO-H053M - COMPLETE CONTENTS

#### GUD-H053M

- A. Motor and gearbox assy with limits and output shaft
- B. 25T sprocket
- C. Operator mounting plate
- D. Drive chain 12B (Not shown)
- E. Operator fastener kit (Not shown)
- F. Manual (Not shown)

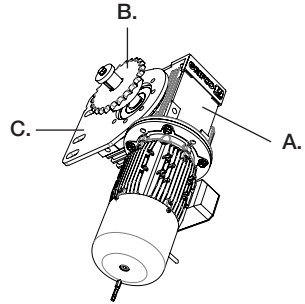

#### GUD-MK-05

- A. Wall bracket LH
- B. Wall bracket RH
- C. Safety brake angle
- D. Flange bearing
- E. Flange bearing fastener kit (Not shown)
- F. Safety brake fastener kit (Not shown)
- G. Wall bracket fastener kit (Not shown)

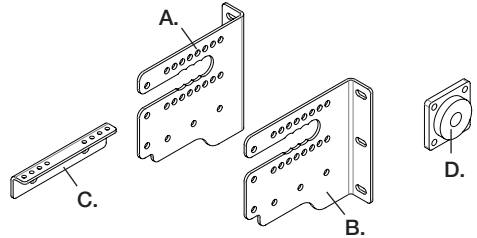

#### GSB-600

Safety Brake

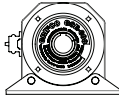

### GUDK-RSO-H073M - COMPLETE CONTENTS

#### GUD-H073M

- A. Motor and gearbox assy with limits and output shaft
- B. 25T sprocket
- C. Operator mounting plate
- D. Drive chain 12B (Not shown)
- E. Operator fastener kit (Not shown)
- F. Manual (Not shown)

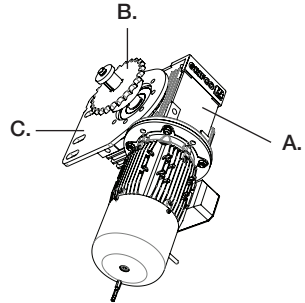

#### GUD-MK-07

- A. Wall angle x 2
- B. Wall bracket x 2
- C. Safety brake angle
- D. Flange Bearing
- E. Flange Bearing Fastener kit (Not shown)
- F. Safety Brake Fastener kit (Not shown)
- G. Wall Bracket Fastener kit (Not shown)

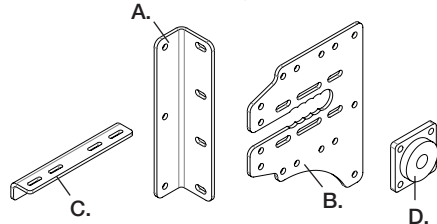

#### GSB-600

Safety Brake

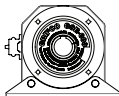

# SELECTION GUIDE 60% DUTY

60% DUTY	GUD-H053M GUD-MK-05	GUD-H073M GUD-MK-07
Drum Diameter	168 mm	168 mm
Curtain Mass	14 kg/m <sup>2</sup>	14 kg/m <sup>2</sup>
Max System Mass	574 KG	800 KG
Max Door Size	20 m <sup>2</sup>	24 m <sup>2</sup>
Max Torque	180 Nm	220 Nm
Max Cycle Time	60s	60s

		Door Height (Drum Axis to Floor)															
		2.5m		3m		3.5m		4m		4.5m		5m		5.5m		6m	
Door Width	Drum Sprocket Teeth	Drum Speed Rpm	Drum Sprocket Teeth	Drum Speed Rpm	Drum Sprocket Teeth	Drum Speed Rpm	Drum Sprocket Teeth	Drum Speed Rpm	Drum Sprocket Teeth	Drum Speed Rpm	Drum Sprocket Teeth	Drum Speed Rpm	Drum Sprocket Teeth	Drum Speed Rpm	Drum Sprocket Teeth	Drum Speed Rpm	
	3m	35	10.0	35	10.0	35	10.0	35	10.0	35	10.0	35	10.0	36	9.7	40	8.8
3.5m	35	10.0	35	10.0	35	10.0	35	10.0	40	8.8	37	9.5	42	8.3	46	7.6	
4m	35	10.0	35	10.0	35	10.0	40	8.8	37	9.5	42	8.3	47	7.4	54	6.5	
4.5m	35	10.0	35	10.0	40	8.8	37	9.5	42	8.3	47	7.4	N/A	N/A	N/A	N/A	
5m	35	10.0	38	9.2	44	8.0	41	8.5	46	7.6	N/A	N/A	N/A	N/A	N/A	N/A	
5.5m	35	10.0	41	8.5	39	9.0	45	7.8	N/A	N/A	N/A	N/A	N/A	N/A	N/A	N/A	
6m	38	9.2	45	7.8	43	8.1	50	7.0	N/A	N/A	N/A	N/A	N/A	N/A	N/A	N/A	
6.5m	41	8.5	50	7.0	46	7.6	N/A	N/A	N/A	N/A	N/A	N/A	N/A	N/A	N/A	N/A	
7m	44	8.0	43	8.1	N/A	N/A	N/A	N/A	N/A	N/A	N/A	N/A	N/A	N/A	N/A	N/A	
7.5m	38	9.2	46	7.6	N/A	N/A	N/A	N/A	N/A	N/A	N/A	N/A	N/A	N/A	N/A	N/A	
8m	41	8.5	50	7.0	N/A	N/A	N/A	N/A	N/A	N/A	N/A	N/A	N/A	N/A	N/A	N/A	



# SELECTION GUIDE 10% DUTY

10% DUTY	GUD-H053M GUD-MK-05	GUD-H073M GUD-MK-07
Drum Diameter	168 mm	168 mm
Curtain Mass	14 kg/m <sup>2</sup>	14 kg/m <sup>2</sup>
Max System Mass	574 KG	800 KG
Max Door Size	24 m <sup>2</sup>	34 m <sup>2</sup>
Max Torque	180 Nm	260 Nm
Max Cycle Time	90s	120s

		Door Height (Drum Axis to Floor)														
		2.5m		3m		3.5m		4m		4.5m		5m		5.5m		6m
Door Width	Drum Sprocket Teeth	Drum Speed Rpm	Drum Sprocket Teeth	Drum Speed Rpm	Drum Sprocket Teeth	Drum Speed Rpm	Drum Sprocket Teeth	Drum Speed Rpm	Drum Sprocket Teeth	Drum Speed Rpm	Drum Sprocket Teeth	Drum Speed Rpm	Drum Sprocket Teeth	Drum Speed Rpm	Drum Sprocket Teeth	Drum Speed Rpm
	3m	35	10.0	35	10.0	35	10.0	35	10.0	35	10.0	39	9.0	44	8.0	48
3.5m	35	10.0	35	10.0	35	10.0	35	10.0	40	8.8	45	7.8	54	6.5	54	6.5
4m	35	10.0	35	10.0	35	10.0	40	8.8	46	7.6	54	6.5	60	5.8	43	8.1
4.5m	35	10.0	35	10.0	40	8.8	45	7.8	54	6.5	60	5.8	39	9.0	48	7.3
5m	35	10.0	38	9.2	44	8.0	50	7.0	57	6.1	43	8.1	48	7.3	54	6.5
5.5m	35	10.0	41	8.5	48	7.3	57	6.1	42	8.3	47	7.4	54	6.5	60	5.8
6m	38	9.2	45	7.8	54	6.5	60	5.8	45	7.8	54	6.5	60	5.8	N/A	N/A
6.5m	41	8.5	50	7.0	57	6.1	43	8.1	50	7.0	57	6.1	N/A	N/A	N/A	N/A
7m	44	8.0	54	6.5	41	8.5	46	7.6	54	6.5	N/A	N/A	N/A	N/A	N/A	N/A
7.5m	33	10.6	37	9.5	44	8.0	50	7.0	N/A	N/A	N/A	N/A	N/A	N/A	N/A	N/A
8m	33	10.6	40	8.8	46	7.6	54	6.5	N/A	N/A	N/A	N/A	N/A	N/A	N/A	N/A

# INSTALLATION

## STEP 1

### INSTALL WALL BRACKETS

Install wall Angle, or Wall Brackets, depending on the system.

GUD-MK-05:

1. Mount Wall Brackets to building using the 3 slots provided
2. Install both sides at the same height.

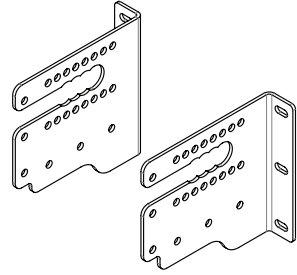

GUD-MK-07:

1. Mount wall Angle to building using the 4 slots provided, for flexibility of install the angle can be mounted with the slots towards or away from the opening.
2. Install both sides at the same height.
3. Install the end plates using the M16 fasteners supplied (Torque 190Nm—210Nm)

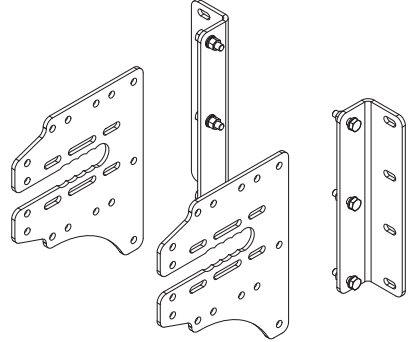

NOTE: Safety brake side, End Plate must be outside of wall angle as shown below

## STEP 2

### INSTALL DOOR DRUM

Install door drum into the bracket slot and position at the correct centre distance from wall. U-Drive mounting brackets feature positional rebates to allow for easy alignment.

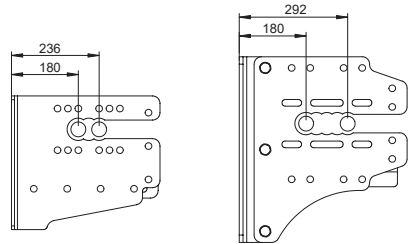

## STEP 3

### INSTALL FLANGE BEARING

Slide the flange bearing over the end of the shaft and use the M16 fasteners supplied.

(Torque 190Nm—210Nm)

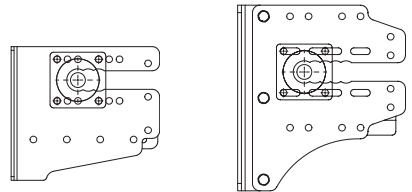

**NOTE: Method of mounting wall brackets to the building structure is dependent on the type and integrity of the wall/structure.**

**The installer must carefully assess the structure and suitably engineer a mounting method to ensure robust and safe installation.**

# INSTALLATION

## STEP 4

### INSTALL SAFETY BRAKE ANGLE

Fit the safety brake angle using M16 fasteners supplied

(Torque 190Nm—210Nm)

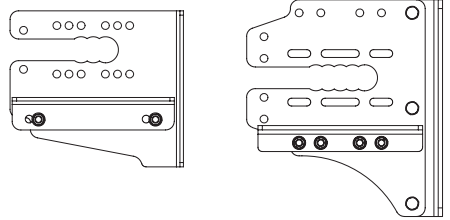

## STEP 5

### INSTALL SAFETY BRAKE

1. Insert 12mm x 8mm x 80mm Key and slide safety brake over shaft.
2. Install M10x40 Fasteners and tighten (Torque 40Nm—44Nm)
3. Install keeper plate using the M10x25 Fastener and tighten (Torque 15Nm—17Nm)

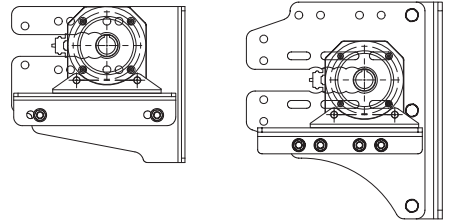

# INSTALLATION

## STEP 6A

### SELECT MOUNTING CONFIGURATION

U-Drive's innovative mounting system allows for various operator mounting positions to best suit the application. This is enabled by the various mounting configurations and operator mounting position.

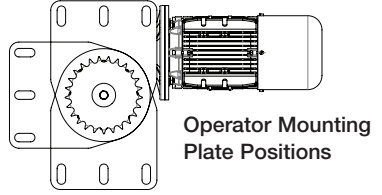

	LEFT HAND CONFIGURATION	RIGHT HAND CONFIGURATION
<b>BELOW, VERTICAL</b>		
<b>BELOW, HORIZONTAL</b>		
<b>FRONT, VERTICAL</b>		
<b>FRONT, HORIZONTAL</b>		
<b>ABOVE, HORIZONTAL (GUD-MK-07 ONLY)</b>		

# INSTALLATION

## STEP 6B

### SELECT IN-BOARD OR OUT-BOARD MOUNTING CONFIGURATION

The operator can be mounted either inside or outside the door bracket.

Consideration should be given to side room clearance requirements.

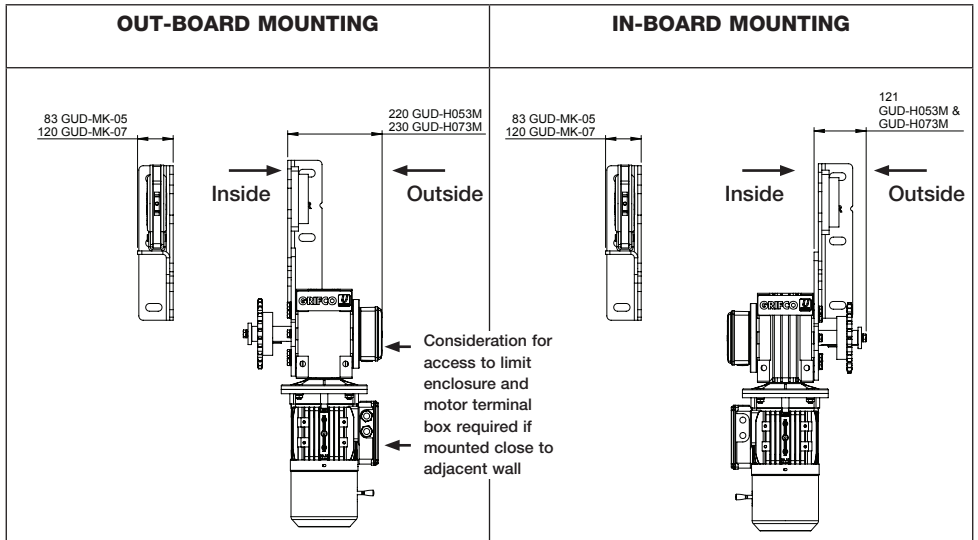

## STEP 7

### INSTALL THE OPERATOR MOUNTING PLATE

Install the operator mounting plate using 8 M10x25 fasteners and spring washers and tighten.

(Torque 20Nm—22Nm)

When the gearbox plate is mounted in this orientation the notch must be located closest to motor flange.

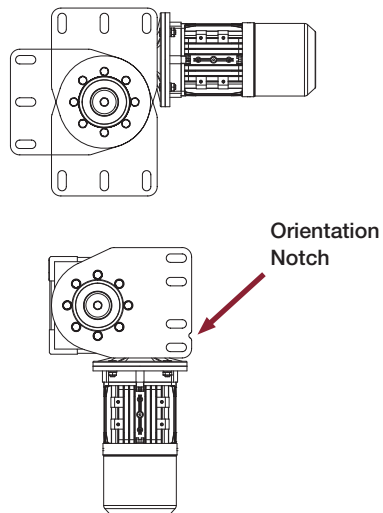

# INSTALLATION

## STEP 8

### MOUNT OPERATOR TO WALL BRACKET

The operator is approx. 30Kg so care should be taken when handling.

Lifting Options:

1. The Operator may be lifted with a soft sling around the motor/gearbox interface
2. Use an Eye-Bolt and nut (not supplied) through one of the gearbox mounting holes (caution - certain positions may cause unbalanced load)

Fit the gear box bracket using M16 fasteners supplied (Torque 190Nm—210Nm)

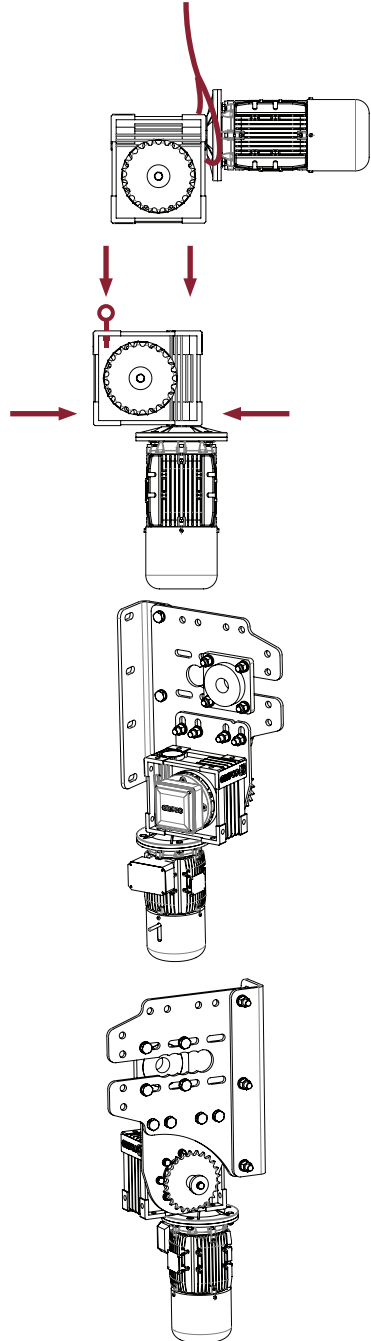

## STEP 9

### INSTALL SPROCKET

1. Install 10mmx8mmx80mm Key and 25T sprocket.
2. Grease is recommended between sprocket and shaft.
3. Install keeper plate and M10x25 Bolt with spring washer (Torque 15Nm—17Nm).

# INSTALLATION

## STEP 9

### INSTALL DRIVE CHAIN

Install the chain ensuring the tension is correct and align the 25T sprocket with the drum sprocket.

NOTE: Ensure that all moving parts are adequately guarded to prevent injury.

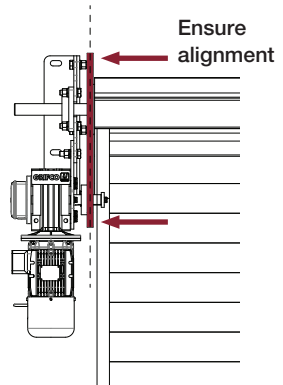

### MECHANICAL INSTALLATION COMPLETE

Mechanical install is now complete! The curtain, rails and any other items specific to the door can now be installed.

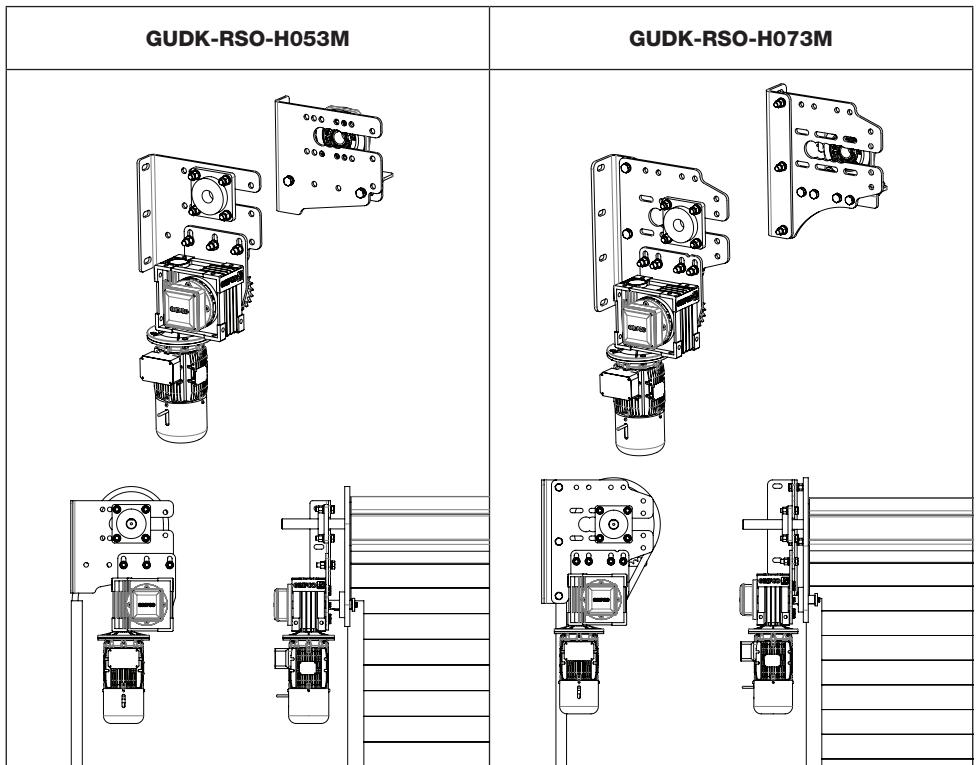

## WARNING

IT IS IMPORTANT TO MAKE SURE THE DOOR ALWAYS RUNS SMOOTHLY. DOORS WHICH STICK OR JAM MUST BE REPAIRED IMMEDIATELY. EMPLOY A QUALIFIED TECHNICIAN TO REPAIR THE DOOR, NEVER ATTEMPT TO REPAIR IT YOURSELF

# ELECTRICAL INSTALLATION

## THE MOTOR, LIMITS AND SAFETY BRAKE MUST:

- be connected via an approved electrical isolation device
- be connected via a suitable circuit breaker that disconnects all live conductors
- be connected in accordance with the wiring rules of the country in which it is installed
- not have control enclosures left open for extended periods (excess dust will void warranty)

## MOTOR CONNECTION

Connect with min.  $0.75\text{mm}^2$  wire using conduit or gland.

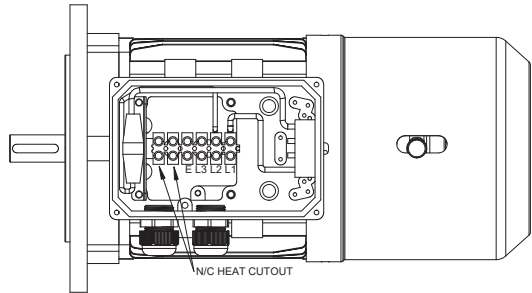

## LIMIT CONNECTION

Connect with min.  $0.75\text{mm}^2$  wire using conduit or gland.

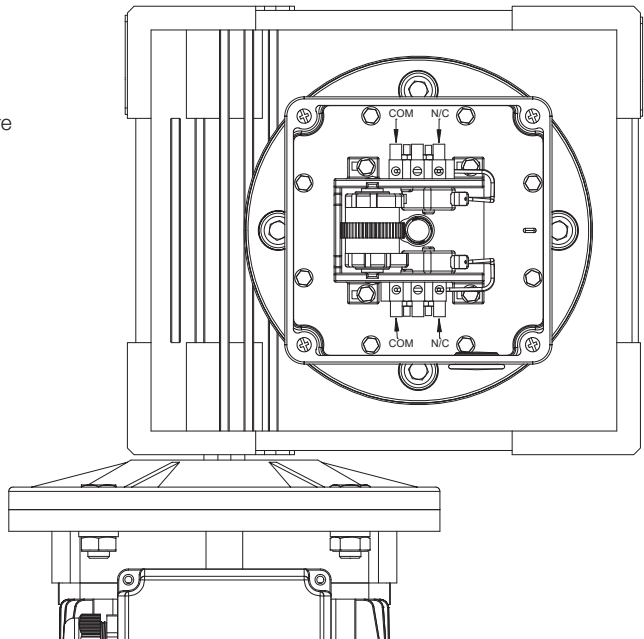

## WARNING

**A DISCONNECTION DEVICE INCORPORATED IN THE FIXED WIRING MUST BE PROVIDED IN ACCORDANCE WITH THE WIRING RULES OF THE COUNTRY IN WHICH IT IS INSTALLED.**



# ELECTRICAL INSTALLATION

## SAFETY BRAKE CONNECTION WHEN USING GLMe2 SERIES LOGIC WALL CONTROLLERS FOR MECHANICAL LIMIT OPERATORS

Connect the safety brake limit switch to the common lead between the limit switches. This will ensure that in event of an activation of the safety brake, the power supply to motor will be cut and no movement will occur until the safety brake is reset or replaced.

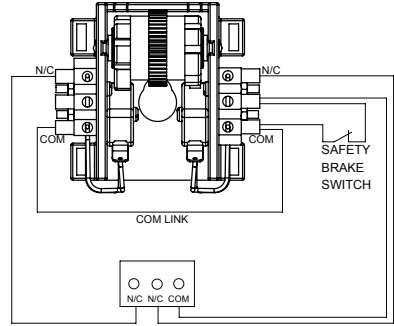

## SAFETY BRAKE CONNECTION WHEN USING RG374 REVERSING STARTER

Connect the safety brake limit switch to the common lead between the limit switches. This will ensure that in event of an activation of the safety brake, the power supply to motor will be cut and no movement will occur until the safety brake is reset or replaced.

NOTE: U-Drive is not compatible with the RG378 Series (415V Coils) Reversing Starters.

For complete electrical install procedure see respective manual (GLMe2 Series or RG374, as included with controller).

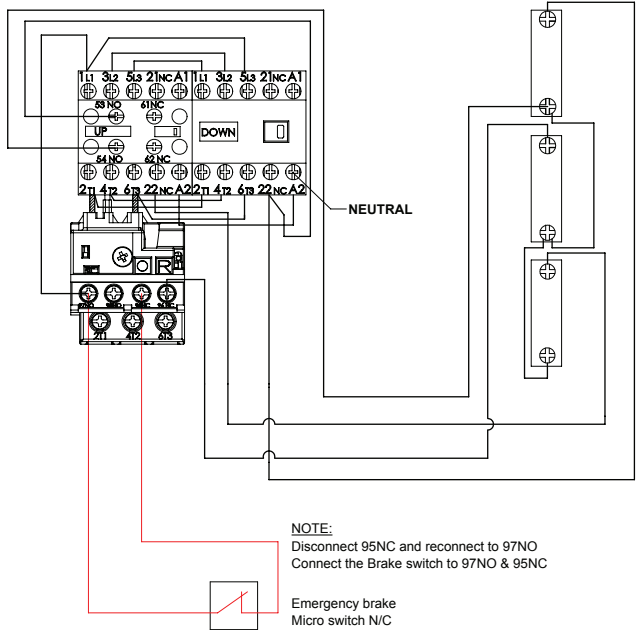

## WARNING

**A DISCONNECTION DEVICE INCORPORATED IN THE FIXED WIRING MUST BE PROVIDED IN ACCORDANCE WITH THE WIRING RULES OF THE COUNTRY IN WHICH IT IS INSTALLED.**

# COMMISSIONING

## SETTING LIMITS

WARNING: Limits are extremely sensitive; a small cam movement may correspond to a large amount of door travel.

- 1 Position one cam to depress a switch (the other should be well clear of the switch)  
Note the switch that you have activated
- 2 Supply power and press the open button momentarily
  - If the door moves up then the limit switch noted above is the bottom limit
  - If the door doesn't move it is the top limit (momentarily press the close button to confirm this)
- 3 Proceed to adjust each friction held cam and operate the door to check the set positions.

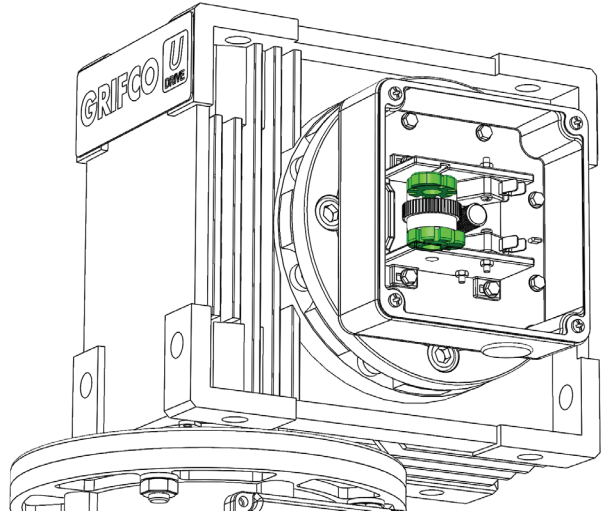

NOTE: The upper limit switch acts as a safety switch, whereby the controller determines if an activation should not be occurring (eg driving away from upper switch, and then the switch activates again in the downward travel direction, before reaching the closed switch). In this case it will stop the motor in either direction. This may occur during limit setting, and therefore could cause confusion.

## WARNING

The Entrapment Protection System for your installation will be determined by the functional requirements of the door. To ensure the installation meets these requirements refer to AS/NZS 60335-2-103.

When using the Grifco® Protector System as part of the Entrapment Protection System, ensure it is installed to detect a 100mm high obstacle, ie; approx 80mm from the floor, and in accordance with installation directions supplied.

Consideration should be given to the detection of vehicles or other similar equipment. To provide adequate Entrapment Protection an additional Grifco® Protector System may be required to be installed in a higher suitable position, for example, approx 600mm from the ground.

## WARNING

When removing or replacing jumpers on all circuit boards, mains power must be disconnected.

## WARNING

It is important to make sure the door always runs smoothly. Doors which stick or jam must be repaired immediately. Employ a qualified technician to repair the door, never attempt to repair it yourself.

# COMMISSIONING

## MANUAL SETTING OF DOOR POSITION

The system can be manually operated for the purpose of setting limits or during the installation before power is connected. This may also be used as a service method provided the system is electrically disconnected and isolated.

A manual operating tool is supplied with the operator to fit into the back of the motor shaft.

Instructions:

1. Insert the tool into the recess on the bottom of the motor
2. Hold the motor brake release lever downward
3. Rotate the tool with suitably powered cordless drill or equivalent

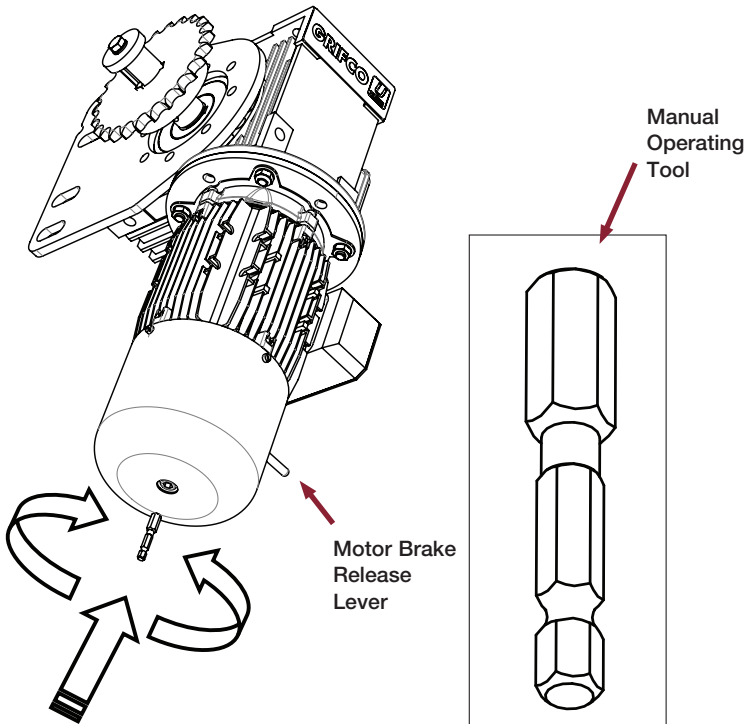

## WARNING

The system must be disconnected from the power supply before attempting to operate manually, risk of injury if the system is operated electronically whilst the manual operating procedure is being carried out. Always isolate before manually operating.

# TROUBLESHOOTING

## TROUBLESHOOTING WHEN USING GLMe2 LOGIC CONTROLS STATUS INDICATOR (GREEN) FLASH / PROBLEM TAB

No. Flashes / Problem	Meaning	Possible Causes	Possible Solutions
Solid ON	Motor running		
2	Infrared beam and/or Bump edge obstruction N/C beam removed	IR beam obstructed Bumper edge pressed The opener has detected removal of an Entrapment Protection Device	<ul style="list-style-type: none"> <li>• Clear obstruction</li> <li>• Remove pressure from bump edge</li> <li>• Set DIP 1 to OFF and press 'reset' (RST) button on MCB for 10 seconds. Relearn any remaining Entrapment Protection Devices</li> </ul>
3	Entrapment Protection Device removed	The opener has detected removal of an Entrapment Protection Device	<ul style="list-style-type: none"> <li>• Set DIP 1 to OFF and press 'reset' (RST) button on MCB for 10 seconds. Relearn any remaining Entrapment Protection Devices</li> </ul>
4	MCB error	Internal Error	<ul style="list-style-type: none"> <li>• Power off, and on. If un-resettable replace MCB</li> </ul>
5	EB internal error	EB disconnected or ignored from MCB	<ul style="list-style-type: none"> <li>• Return EB to the installation or resolve EB issue, refer EB1 Manual</li> </ul>
10	Run time error	Extreme Motor Overload	<ul style="list-style-type: none"> <li>• Power off. Check for door damage causing an obstruction. Clear obstruction</li> <li>• Upgrade to larger operator</li> </ul>
12	Thermal overload	Motor overheating	<ul style="list-style-type: none"> <li>• Use opener less frequently</li> <li>• Upgrade to a high cycle opener</li> </ul>
14	Direction error	Motor connections altered	<ul style="list-style-type: none"> <li>• Change door direction and reset limits</li> </ul>
Constant flash	Due for service	Door is due for routine service	<ul style="list-style-type: none"> <li>• Contact your local door dealer to arrange service</li> </ul>
No Lights Displayed	Power failure – No lights on MCB or Controller *With lights on at MCB	Power supply not correctly connected *Bad connection to Controller	<ul style="list-style-type: none"> <li>• Check transformer</li> <li>• Check power supply wiring</li> <li>• *Refer below if lights are on at MCB and not on Controller</li> </ul>
Push button not responding	Opener does not drive up and / or down	Bad connection to Controller Damaged Controller cable Controller buttons forced and dislodged from rear of lid	<ul style="list-style-type: none"> <li>• *Check RJ45 plugs are clipped in securely at Controller and MCB</li> <li>• *Check connections</li> <li>• *Replace Controller cable</li> <li>• *Replace Controller</li> </ul>
Open or Close button not responding but green light comes on	Coil failure or incorrect motor wiring if green light on whilst holding up or down button and opener does not move in one direction	Extreme vibration or impact during transit Incorrect motor terminal connection	<ul style="list-style-type: none"> <li>• Replace MCB</li> <li>• Correctly wire the motor</li> </ul>
Yellow LED on	Limits error or Safety brake engagement	Limits circuit open from a wiring fault or a mechanical failure has caused Safety brake engagement	<ul style="list-style-type: none"> <li>• Power off. Check for mechanical failure</li> </ul>

# TROUBLESHOOTING

## 1. NO INDICATOR LIGHTS ON CONTROLLER:

Are there any indicator lights ON the MCB (Main Control Board)?

- YES Check connection between MCB and wall control. Check for damage to control cable
- NO Check power supply

## 2. POWER LIGHT ILLUMINATED ON CONTROLLER BUT DOOR WILL NOT GO UP:

Does the green status light come ON when button is being pressed?

- YES Check for loose motor terminal connection
- NO Check for control circuit isolating switch or connection between MCB and controller  
Check for damage to control cable

## 3. POWER LIGHT ILLUMINATED ON CONTROLLER BUT DOOR WILL NOT GO DOWN:

Is the green status light flashing 2 or 3 times?

- YES 2 times - check for obstructions or IR beam misalignment  
3 times - check for persistent IR beam obstruction, misalignment or bump edge Wiring problem. Check for correct wiring connection and DIP switch settings on MCB

NO Continue onto next question

Does the green status light come ON when down button is being pressed?

- YES Check for loose motor terminal connection
- NO Check for control circuit isolating switch or connection between MCB and controller  
Check for damage to control cable

## 4. OPENER ACTIVATES FROM CONTROLLER BUT NOT REMOTES:

Are limits set?

- YES Change remote battery. Check key switch (if installed) position is in Auto or Auto/Man and check MCB and Expansion board (if fitted) DIP switches are set correctly. Check that remote is learned and MCB is picking up signal
- NO Set limits.

## 5. WORKS FROM CONTROLLER BUT AUTOMATIC FUNCTIONS DO NOT:

(only applicable when using an Expansion Board)

Is there a solid orange (COMS) light on the Expansion Board?

- YES MCB (Main Control Board) must be reset. Call Chamberlain (1800 GRIFCO) for resetting procedure
- NO Make sure key is in correct position

## 6. POWER LIGHT INTERMITTENTLY GOES OFF AND ON:

Is the power light going off on the MCB also?

- YES Check supply wiring
- NO Check connection between MCB and controller. Check for damage to control cable



**WARNING**

Power **MUST** be turned off before servicing or adjusting the opener.  
Disconnect the supply when cleaning!

# MAINTENANCE

Frequently examine the installation for signs of wear or damage. Do not use if repair or adjustment is necessary. Power must be turned off before servicing, cleaning or adjusting the opener.

Certain mechanical aspects of the installation as applicable must be checked, see below:

## MONTHLY

- Examine the installation for signs of wear or damage. Do not use if repair or adjustment is necessary \*
- Check chain alignment, tension and condition. Adjust / replace if required \*
- Check PE / IR beam/s and bump edge functionality where applicable

## QUARTERLY

- Check tightness of fixing bolts and (sprocket) grub screws. Adjust if required \*
- Check correct electrical operation
- Check manual operation as per the respective "Installation and users Manual"
- Lubricate the drive chain \*

\* SERVICE MUST BE CARRIED OUT BY A QUALIFIED TECHNICIAN

## CHECK DOOR CYCLE COUNT

Door cycle count can only be checked if the GLMe2L Logic Controller is installed. Limits must be set.

- Drive door to closed limit
- Press and hold CLOSE for 10 seconds
- After 10 seconds and while still holding CLOSE, press and release the SET button
- Status LED will light up indicating number of cycles performed

To read number of cycles, follow the 'Reading Status Flashes' routine described below.

Reading Status Flashes (GLMe2 controllers only)

STATUS indicator will start flashing to signify the value of the least significant digit of the overall number. A solidly lit indicator stands for zero.

Press set to view the next digit.

Continue previous step until the STATUS indicator flashes quickly for 1 second then goes out. This signifies that the entire number has been displayed.

To reset error (GLMe2 controllers only)

(This process indicates there has been a severe problem. Persistent resetting will void warranty and may damage the door and/or opener). This procedure will only work when the status light is flashing 4, 5, 9, 10, 14 or 15 times.

Hold the STOP button for 10 seconds

While still holding the STOP button, press and release the SET button

The STATUS indicator should flash quickly for 1 second. Any errors that were flashing should have stopped.



Power **MUST** be turned off before servicing or adjusting the opener.  
Disconnect the supply when cleaning!



# CHAMBERLAIN LIMITED WARRANTY

Chamberlain Australia Pty Limited / Chamberlain New Zealand Limited (Chamberlain) is committed to manufacturing and supplying high quality goods. As part of this commitment, we seek to provide reliable service and support for our goods and are pleased to provide you, the original purchaser, with this Chamberlain Limited Warranty.

We also provide the following statement as required by the Australian Consumer Law: In Australia, in addition to your rights under this Chamberlain Limited Warranty, our goods come with guarantees that cannot be excluded under the Australian Consumer Law. You are entitled to a replacement or refund for a major failure and for compensation for any other reasonably foreseeable loss or damage. You are also entitled to have the goods repaired or replaced if the goods fail to be of acceptable quality and the failure does not amount to a major failure.

## Chamberlain's U-Drive Warranty

Chamberlain warrants to the original purchaser of the Grifco U-Drive product (Operator) that:

- 1 The U-Drive operator (including electric motor) is free from defects in materials and workmanship for a period of 2 years from the date of purchase or 50,000 cycles (which ever comes first). Cycles can be determined by following the instructions in the manual.
- 2 During the applicable Chamberlain Warranty period, if you are concerned that the Operator or electric motor may be defective, call our service centre on the toll free number below before removing the operator and a Chamberlain technician will diagnose the problem. \

Once the problem has been diagnosed, subject to your rights under the Australian Consumer Law with respect to major failures, Chamberlain will provide you with:

- 1 parts for "do-it-yourself" repairs; or
- 2 shipping instructions for a factory repair or replacement.

If a factory repair or replacement is required, provided the defective part or Operator is returned to Chamberlain well-packaged and in accordance with Chamberlain's shipping instructions, Chamberlain will, subject to your rights under the Australian Consumer Law with respect to major failures:

- 1 in relation to the Operator, repair or, at its option where permissible, replace any defective part or Operator and return it to you at no cost; and
- 2 Where the Operator has been installed by an authorised installer, you must call them for prompt on-site service. Chamberlain will furnish replacement parts free of charge through the authorised installer. A service fee for on-site service may apply. Repairs and replacement parts provided under this Chamberlain Limited Warranty are provided free of charge and are warranted for the remaining portion of the original warranty period. This Chamberlain Limited Warranty provides benefits which are in addition to your other rights and remedies as a consumer.

## Exclusions

If our service centre determines that a warranty claim has been made in respect of a failure or defect arising under or out of any exclusion detailed below such that the claim is not covered under this Chamberlain Limited Warranty, we may, subject to your other rights and remedies as a consumer, charge you a fee to repair, replace and/or return the Operator to you.

This Chamberlain Limited Warranty does not cover any failure of, or

defect in, the Operator due to:

- 1 non-compliance with the instructions regarding installation, operation, maintenance and testing of the Operator or of any product with which the Operator is used;
- 2 any attempt by a person other than an authorised installer to change settings, repair, dismantle, reinstall or move the Operator to another location once it has been installed;
- 3 tampering, neglect, abuse, wear and tear, accident, electrical storm, excessive use or conditions other than normal commercial use;
- 4 use of the Operator in conjunction with controls which have not been supplied, or pre-approved, by Chamberlain;
- 5 problems with, or relating to, the commercial door or commercial door hardware, including but not limited to the door springs, door rollers, door alignment, hinges, guides, slats and drums; or
- 6 problems caused by electrical faults.

If this Chamberlain Limited Warranty does not apply, you may have rights available to you under the Australian Consumer Law.

## Liability – Australia only

Except as set out in the Australian Consumer Law (being Schedule 2 of the Competition and Consumer Act 2010) (as amended, consolidated or replaced):

- 1 all other guarantees, warranties and representations in relation to the Operator or its supply are excluded to the extent that Chamberlain can lawfully exclude them; and
- 2 under no circumstances will Chamberlain be liable for consequential, incidental or special damages arising in connection with the use, or inability to use, the Operator, other than those which were reasonably foreseeable as liable to result from the failure.

## Liability – New Zealand only

Except as set out in the Fair Trading Act 1986 and the Consumer Guarantees Act 1993 (as amended, consolidated or replaced):

- 1 all other guarantees, warranties and representations in relation to the Operator or its supply are excluded to the extent that Chamberlain can lawfully exclude them; and
- 2 under no circumstances will Chamberlain be liable for consequential, incidental or special damages arising in connection with the use, or inability to use, the Operator, other than those which were reasonably foreseeable as liable to result from the failure.

## Note

We request that you retain your sales docket or invoice as proof-of-purchase and attach it to this manual to enable you to establish the date of purchase in the unlikely event of a warranty service being required. Chamberlain reserves the right to change the design and specifications of the Unit without prior notification. Some features or accessories of the Unit may not be available in certain markets or areas. Please check with your distributor.

## Chamberlain service centre contact details

**Australia - Phone toll free 1800 474 326**  
**Fax toll free 1800 888 121**  
**Unit 1, 75 Epping Road North Ryde, NSW 2113**

**New Zealand - Phone toll free 0800 653 667**  
**Fax toll free 0800 653 663**

**customerservice@chamberlainnz.com**  
**www.grifco.com.au or www.grifco.co.nz**