

TM-27 Single Button Handset

Programming New or Additional Handsets

The following instructions demonstrate how to program a new or additional Gliderol Single Button Handset to suit most Gliderol operators pre-1998. Older Gliderol units operate using either Trinary or Binary coding. Trinary units will have a 9 digit code shown inside the operator Control Box, whereas Binary units will have two 8 digit codes inside their Control Box. Please refer to the appropriate set of instructions to successfully program your new Gliderol Single Button Handset.

Trinary Handset Coding - 9 digit code

Step 1:



Remove the cover from the handset to expose the handset circuit board.

Step 2:

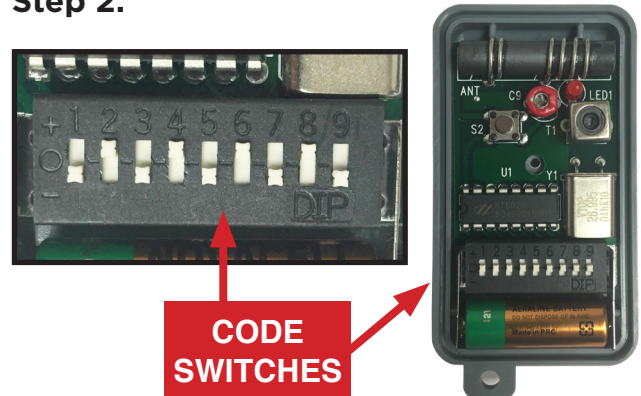

Push the numbered switches 'up' or 'down' to reflect the same code shown inside your existing control box.

Your handset programming is now complete!



Should you require further assistance in programming your Gliderol Single Button Handset please contact your local Gliderol office on 1300 799 177.

WARNING

To prevent possible SERIOUS INJURY or DEATH:

- Battery is hazardous: NEVER allow children near batteries.
- If battery is swallowed, immediately notify a doctor.

To reduce risk of fire, explosion or chemical burn:

- Replace ONLY with the same size and type battery
- DO NOT recharge, disassemble, heat above 100° C or incinerate

Battery will cause SEVERE or FATAL injuries in 2 hours or less if swallowed or placed inside any part of the body.



TM-27 Single Button Handset

Programming New or Additional Handsets

The following instructions demonstrate how to program a new or additional Gliderol Single Button Handset to suit most Gliderol operators pre-1998. Older Gliderol units operate using either Trinary or Binary coding. Trinary units will have a 9 digit code shown inside the operator Control Box, whereas Binary units will have two 8 digit codes inside their Control Box. Please refer to the appropriate set of instructions to successfully program your new Gliderol Single Button Handset.

Binary Handset Coding - 16 digit code (2 x 8 digit codes)

Binary to Trinary Conversion Table

BINARY SWITCH A	UP	UP	DOWN	DOWN
BINARY SWITCH B	UP	DOWN	UP	DOWN
HANDSET (TRINARY) SWITCH	DOWN	UP	MIDDLE	MIDDLE

Step 1:

Fill out the below table using both of the 8 digit codes inside your control box. Identify if the switch is in the 'UP' or 'DOWN' position.

Binary Switch A

1	2	3	4	5	6	7	8

Binary Switch B

1	2	3	4	5	6	7	8

Step 2:

Using the information collected in Step 1, use the 'Binary to Trinary Conversion Table' to determine your new handset code. **Please note, these numbers are not in sequence** (eg the second digit in your handset code is the result of the third digits from your control box code). The ninth digit is always in the 'DOWN' position.

Handset Code

1	3	4	6	7	2	5	8	9
								DOWN

Using your new 'Handset Code', follow the 'Trinary Handset Coding' instructions to complete your Handset programming.