

Creating Superior Locks Since 1946

T HANDLE LOCK INSTALLATION & CONFIGURATIONS

SUITABLE FOR

- GARAGE TILT-A-DOORS
- ELECTRICAL CABINETS
- TOOL BOXES
- GATES
- CAR UTE CANOPIES

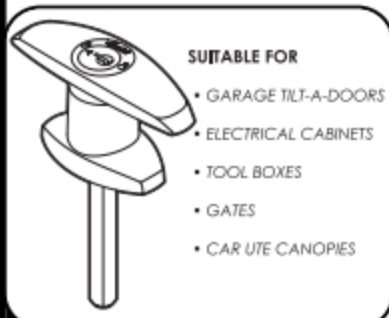

MULTIPLE BARRELS

The Lenlok CBS T&L Handles range is available in 3 wafer barrels, C4, LF6R & LW3. Existing Lenlok T handle keys can use the LW3 wafer barrel. Mastered wafers are available for the LF6R wafer barrel.

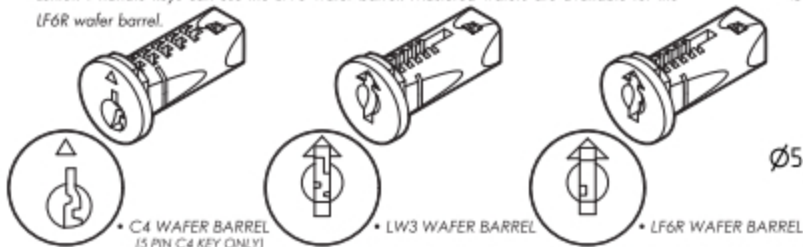

CUT OUT SIZE

Using a $\varnothing 12\text{mm}$ drill bit, drill a hole for the spindle and using a $\varnothing 5.50\text{mm}$ drill bit, drill 2 x holes 44.50mm apart for the fixing screws.

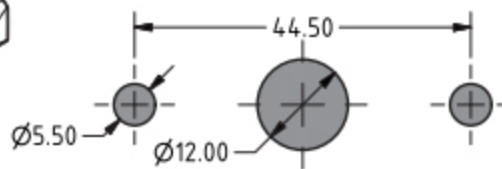

PACKAGED COMPONENTS

- $\frac{3}{16}$ Threaded Rod (REAR FIX MODELS)
- OR
- $\frac{3}{16}$ Threaded Rod & Cap (FRONT FIX MODELS)
- $\frac{3}{16}$ Nut
- Washer

TOOLS REQUIRED

- $\varnothing 5.50\text{mm}$ Drill Bit
- $\varnothing 12.00\text{mm}$ Drill Bit
- Adjustable Spanner

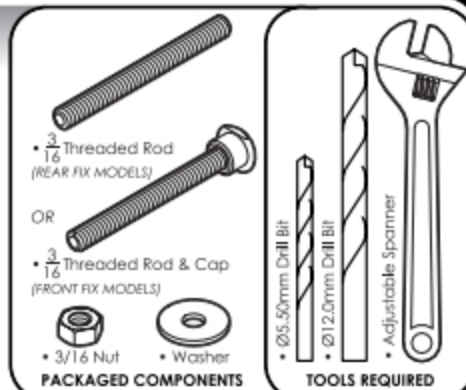

MULTIPLE HANDING CONFIGURATIONS

The handing plates needs to be to be unscrewed, removed from the spindle and then re-installed to the desired configuration.

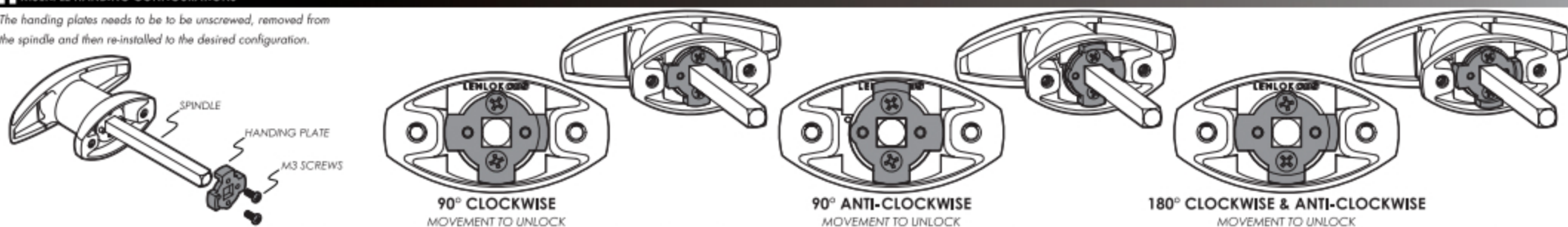

INTERCHANGEABLE SPINDLE (For changing spindle lengths)

To change the length of the spindle the handing plate needs to be unscrewed and removed from the spindle. The new spindle is then installed and the handing plate is re-fitted to the secure the spindle.

*Note
Larger spindles are available

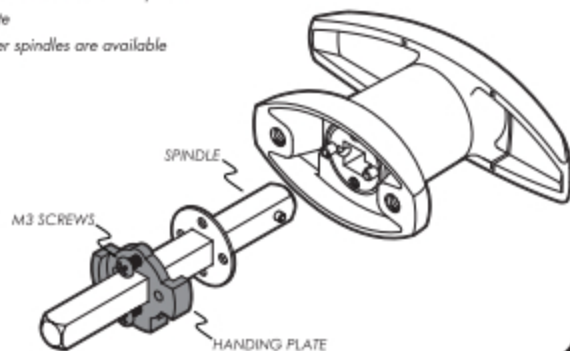

FRONT FIX & REAR FIX

Rear fix models are supplied with 2 x $\frac{3}{16}$ threaded rods, 2 x $\frac{3}{16}$ nuts and 2 x washers. Front fix models are supplied with the same above mentioned components, plus 2 hardened rod caps. These caps are hardened to prevent drilling of the fixing screws

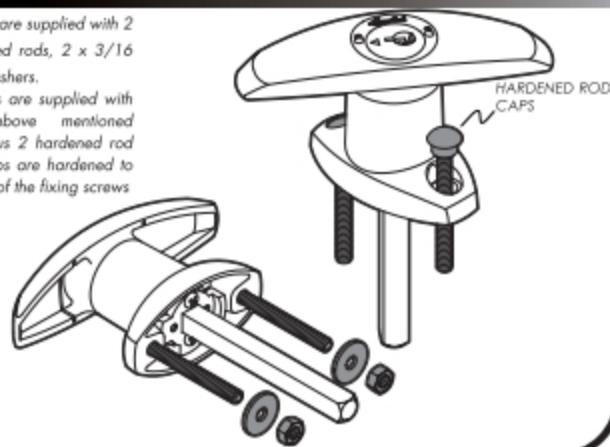

KEY RETAIN

To enable key retain mode, insert a $\varnothing 1.50\text{mm}$ roll pin into the front face of the T handle where the barrel goes (see diagram item 1) and insert a second roll pin in the hole in the escutcheon (see diagram item 2).

To determine the correct hole in the escutcheon, it is located where the handing plate stops when the lock is unlocked.

*Note
Roll pins are supplied separately

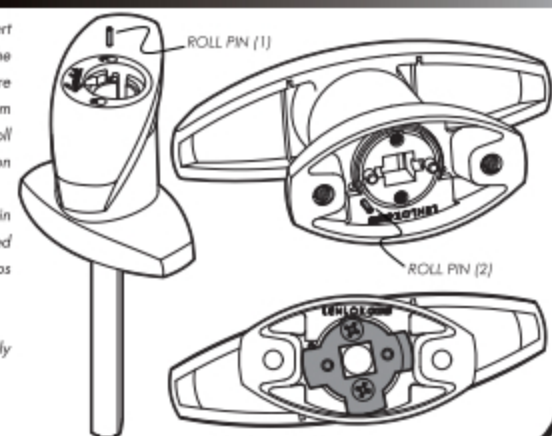

Creating Superior Locks Since 1946

T HANDLE LOCK WAFER BARREL REMOVAL

1. REMOVE THE T HANDLE

In order to remove the wafer barrel from the T handle, the T handle needs to be removed from its installed location.

Using a 5/16" spanner or adjustable spanner, remove the fixing nuts and any other auxiliary hardware which has been installed.

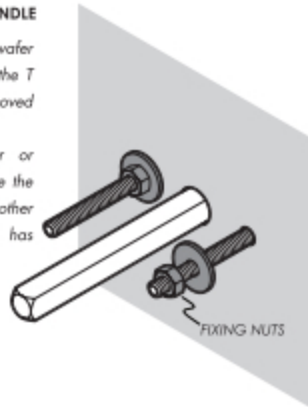

2. REMOVING THE SPINDLE & HANDING CAM

Using a philips head screw driver, remove the 2 x M3 screws on the bottom side of the T handle. Remove the handing cam, nylon washer & spindle has one whole unit.

*Note
Take note of the orientation of the handing cam.

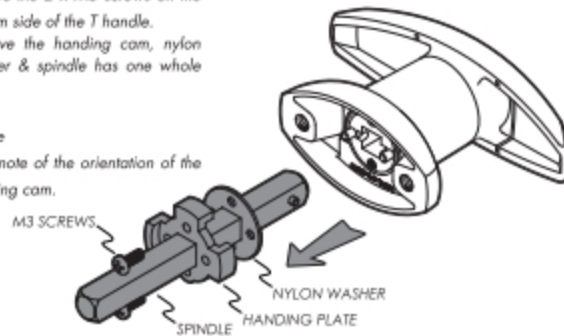

3. SEPARATING THE ESCUTCHEON & UPPER HANDLE

In order to remove the escutcheon, the handle needs to be rotated 45° counter clockwise.

*Note
The lock must be in the unlocked position. The indicator on the barrel must be facing towards the unlocked symbol.

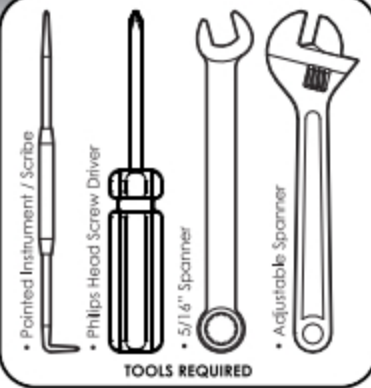
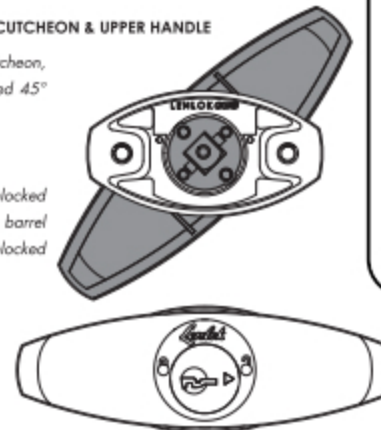

4. REMOVE THE ESCUTCHEON

Once the upper handle has been rotated, remove the escutcheon.

*Note
Please note not to remove any grease which has been installed on the upper handle & escutcheon.

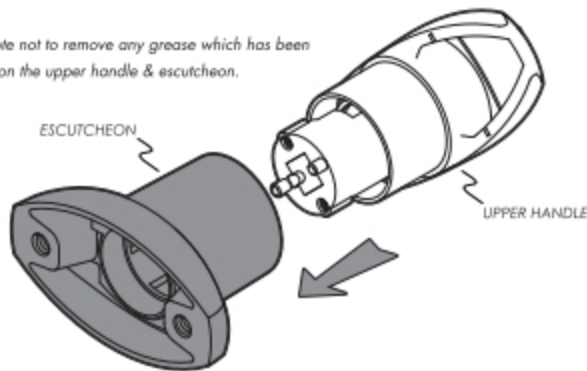

5. PRESSING IN THE RETAINING WAFER

Using a pointed instrument or a scribe, locate the retaining wafer and press in the retaining wafer, until the top curvature of the retain wafer matches the curvature of the barrel.

*Note
The lock must be in the unlocked position. The indicator on the barrel must be facing towards the unlocked symbol.

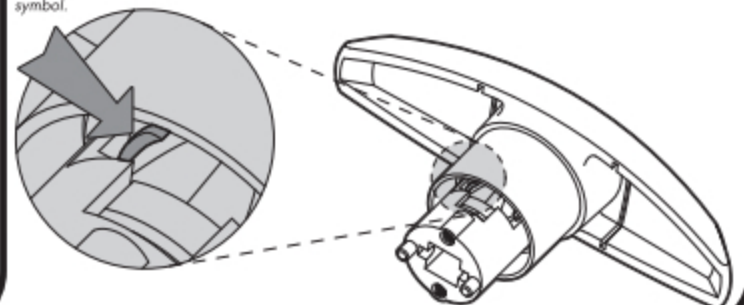

6. REMOVING THE WAFER BARREL

Once the retaining wafer has been pressed downwards, slide the wafer barrel out of the upper handle.

*Note
A key is recommended to be inserted into the wafer barrel, to help secure the wafers.

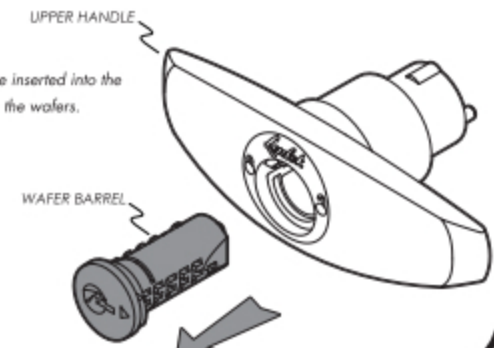

INSERTING THE WAFER BARREL

Before inserting the wafer barrel, reverse the above mentioned procedures.

*Note
The T handle must be in the unlocked position

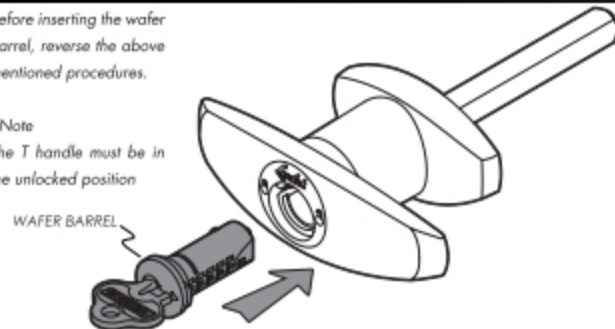

Partially insert the wafer barrel, until the retaining wafer is preventing the barrel from entering. Press in the retaining wafer with a pointed instrument or scribe.

Once the retaining wafer has been pressed in, continue to insert the rest of the wafer barrel. Once fully inserted, the retaining wafer should expand and lock the wafer barrel in place.

*Note
The pip on the rear of the wafer barrel, must be aligned with the locked symbol on the front face.

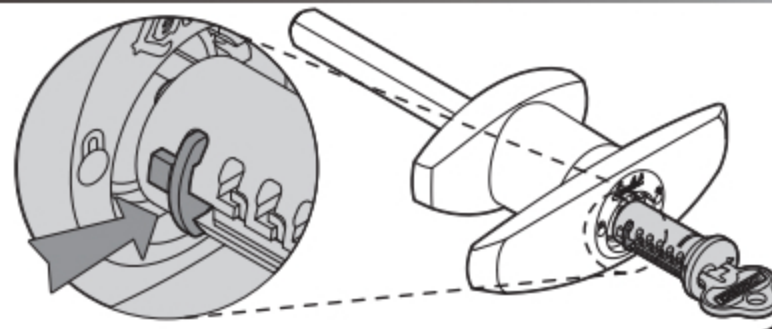

WARNING
Please keep contents away from small children, may lead to suffocation.

NOTE
Please dispose of plastic bags & other packaging in a thoughtful manner.

