

REMOTE PRO

PROGRAMMING INSTRUCTIONS



CAME

PROGRAM YOUR NEW CAME REMOTE FROM YOUR ORIGINAL REMOTE

During the coding process, if you press one of the buttons of the already programmed remote control first, you run the risk of erasing the codes of all the remote controls that have already been programmed.

1. Press both top buttons on your new remote control at the same time. Keep them pressed down. The LED light on your new remote will blink slowly and then faster. Let the buttons go. Press the button of your new remote control. Let it go. The LED light on your new remote control will remain lit constantly.
2. Place an already-programmed remote control next to the new remote control the light on your new remote control is lit constantly (5 seconds only), press the same button on the old remote control that you pressed on the new remote control until the LED light on the new remote will blink three times.
3. Test your remote. Repeat the procedure for each button you wish to program.

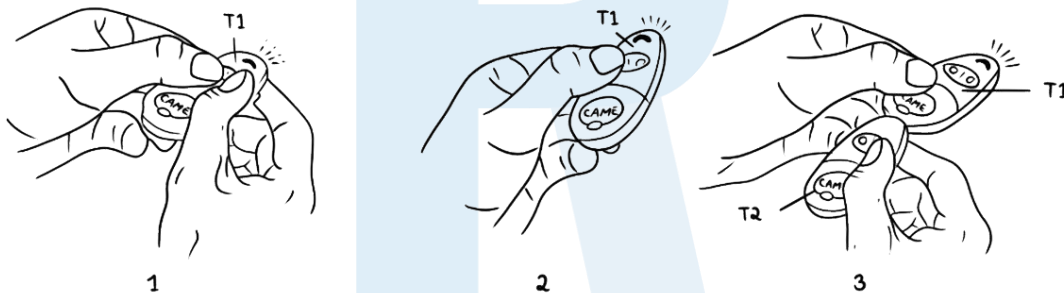

PROGRAM YOUR NEW CAME REMOTE DIRECTLY TO YOUR RECEIVER

1. Open the casing of your receiver. It is located next to your motor.
2. On the receiver circuit board, press the 'CH1' button.
3. While keeping the 'CH1' button pressed down, press the first button on your new remote control. Let the buttons go.
4. On the receiver circuit board, press the 'CH2' button.
5. While keeping the 'CH2' button pressed down, press the second button on your new remote control. Let the buttons go.
6. Test your remote.

WARNING

This product may contain a coin/button cell battery. Keep product and batteries away from children. A battery can cause severe or fatal injuries in 2 hours or less if swallowed or placed inside any part of the body. Seek immediate medical attention if it is suspected that a coin/button cell battery has been swallowed or placed inside of any part of the body.

