

Smart Phone Control Kit

Smart Hub Installation Instructions

Garage Door Openers

NETWORK SMART HUB KIT - ORDER NO. 14880		
ITEM	DESCRIPTION	QTY
1	WIRELESS HUB100 WT B&D	1
2	POWER SUPPLY AU 240V	1
3	WALL BRACKET HUB100	1
4	PLASTIC WALL PLUG 6.9 X 25	2
5	SELF TAPPING SCREW 6 X 25	2

TRANSCIVER KIT NTR-1V1 - ORDER NO. 14818		
ITEM	DESCRIPTION	QTY
6	NETWORK TRANSCIVER NTR-1V1 AY	1
7	TIMING HARNESS 400MM VR12 AY	1
8	TAPTITE SCREW "P" M4 X 12	2
9	VELCRO 20 X 50	1

This device must be connected to power at all times. **DO NOT** disconnect power after setup.



Installation Video

To view step by step installation guide video, download a QR Code Reader App from your App Store and scan this code.



This device allows for operation of the door/gate when not in line-of-sight of the door/gate and opener.

The door/gate may operate unexpectedly, therefore do not allow anything to stay in or near the path of the door/gate. When the door/gate is not operating automatically, watch the door/gate when it is moving and keep people away until the door/gate is completely opened or closed. **Contact with the moving door/gate can cause serious personal injury or damage to property.**



It is our strong recommendation that your opener be fitted with **SAFETY BEAMS**. Safety Beams detect any obstructions in the door/gate's path and override automatic operation if one presents. These must be installed as in accordance with AS/NZS 60335-2-95:2012.

This is in addition to regular professional servicing, and monthly obstruction tests as detailed in your opener's Home Owners Manual.

Important Safety Instructions



WARNING!

- DO NOT attempt to disassemble, repair or modify the product. This will invalidate the warranty.
- DO NOT install product on openers that control J-Type or Single Piece Doors.
- Do not allow children to play with the Smart Hub or your smart phone if the B&D phone app has been installed.



ELECTROCUTION!

- Keep the device away from water and other liquids. In the event that water or other liquids enter the device, power off the product immediately and clean the device.
- To reduce the risk of fire or electric shock, do not expose this device to rain or moisture. The device should not be exposed to dripping or splashing.
- DO NOT remove the cover as there are no user-serviceable parts inside.



CAUTION:

Fall from ladder

Burns

- Ensure ladder is the correct type for job.
- Ensure ladder is on flat ground.
- Ensure user has 3 points of contact while on ladder.
- DO NOT handle damaged or leaking batteries
- The battery backup kit contains sealed lead-acid batteries that must be disposed of properly at the end of their useful life.

Smart Hub Set Up

Mounting the Hub

- a. Determine whether you are going to wall mount the hub.
 - i. If hub is to be placed on bench, simply connect to power supply (2), turn on and proceed to installing the Transceiver.
 - ii. If hub is to be wall mounted follow steps below.
- b. To wall mount - Use wall bracket (3) as template to mark where to drill holes. Pre-drill holes.
 - i. For plaster walls - insert (2) two Plastic wall plugs (4) into holes, place wall bracket over holes and affix with (2) two self tapping screws (5).
 - ii. For brick walls - place wall bracket (3) over holes and affix with (2) two self tapping screws (5).
- c. Slide the hub over the bracket.
- d. Connect the power supply (2) and turn on.

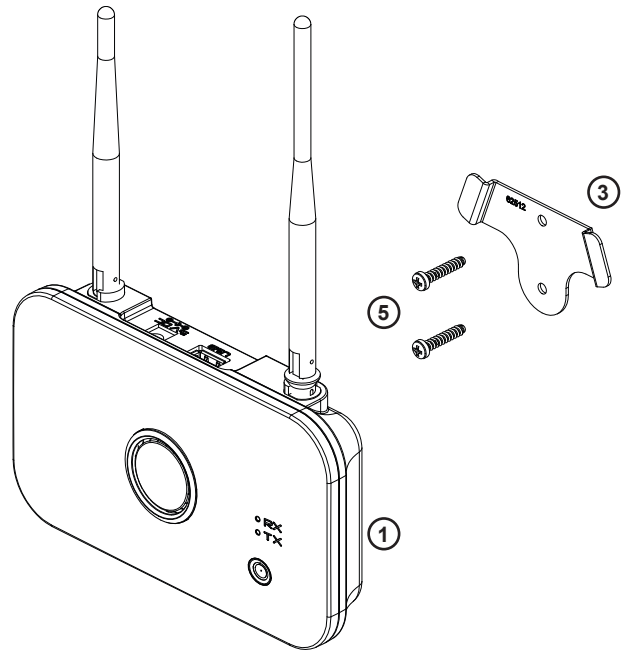

This device must be connected to power at all times. DO NOT disconnect power after setup.

Roller Door Opener Set Up

GDO-6

Preparation of Opener

- a. Disconnect the power supply to the opener.
- b. Remove the light diffuser via screw at the bottom.
- c. Remove the grommet out of the back cover.
- d. Cut (1) one side of the grommet with a knife or scissors.
- e. Slide the network timing harness (7) into the cut in the grommet.
- f. Refit grommet to back cover by sliding the harness through hole before fitting grommet.
- g. Connect the harness to the network pin on the control board.
- h. Refit the light diffuser.

Mount and connect Transceiver

- a. Plug the other end of the harness into the transceiver (6).
- b. Place the transceiver (6) on the side of the opener to the black, back cover so that the screw holes on the transceiver line up with those on the back cover.
- c. Secure transceiver using the (2) two Taptite M4 x 12 screws (8) or velcro (9).

Re-setup and Test the Opener

- a. Reconnect power and remove the button cover.
- b. Setting Limits:
 - i. If limits have not been set, follow the openers installation sheet to set limits.
 - ii. If limits were set previously, clear limits and follow openers installation sheet to set limits.
- c. Refer to the Smart Phone Control Kit User Guide to set up network capabilities.

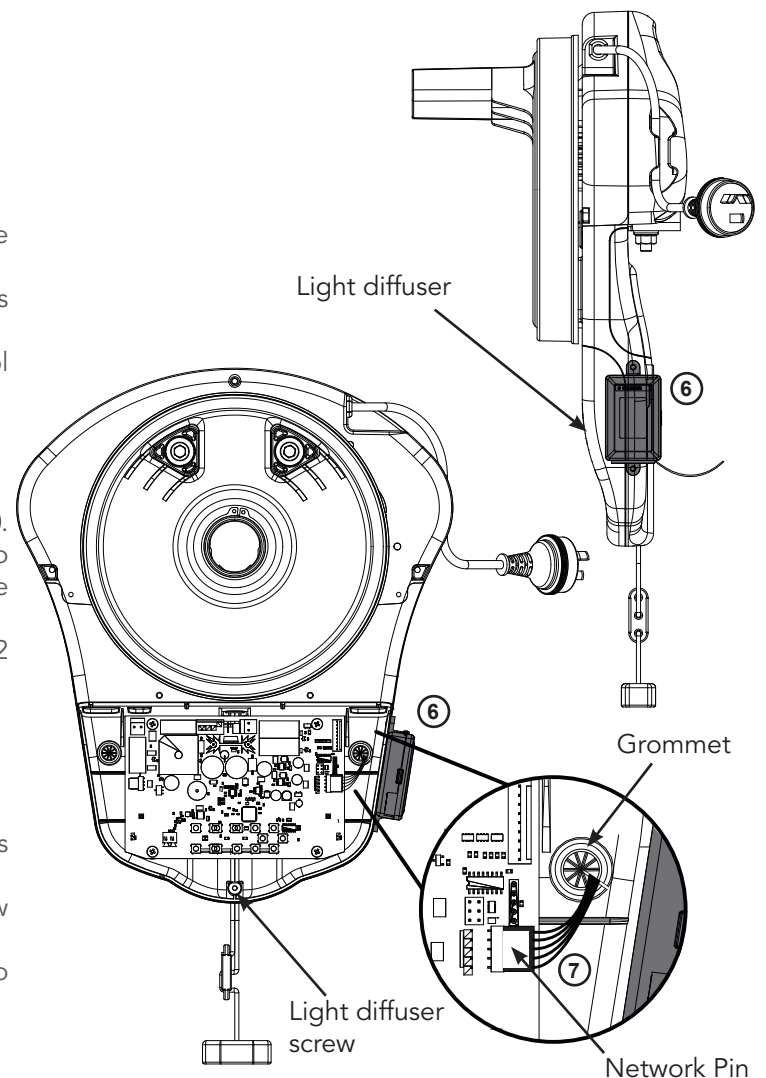

Sectional Door Opener Set Up

GDO-9V2, GDO-9V3 and GDO-11

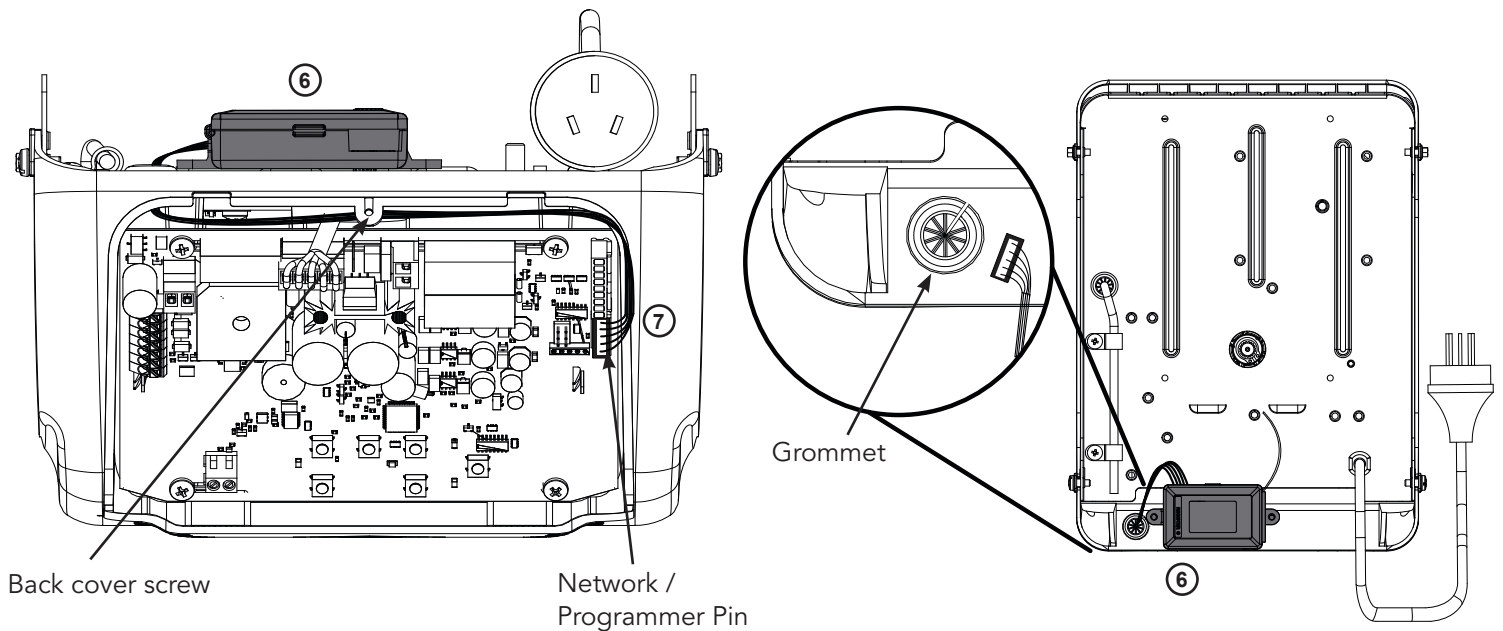

GDO-11

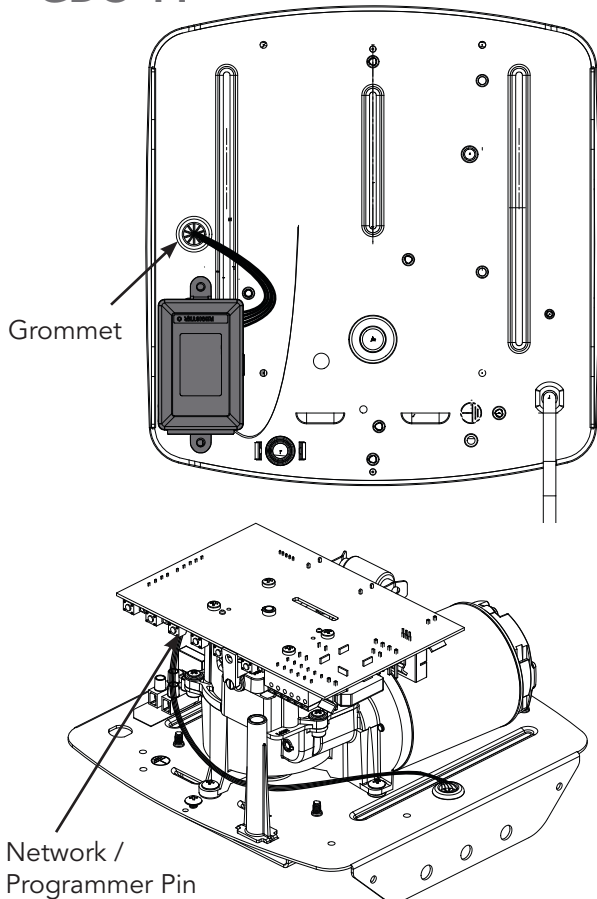

Preparation of Opener

- Disconnect the power supply to the opener.
- Remove the cover or back cover via screw at top.
- Remove the grommet out of the chassis.
- Cut (1) one side of the grommet with a knife or scissors.
- Slide the network timing harness (7) into the cut in the grommet.
- Refit grommet to chassis by sliding the harness through hole before fitting grommet.
- Connect the harness to the network / programmer pin on the control board.
- Refit the cover.

Mount and connect Transceiver

- Plug the other end of the harness into the transceiver (6).
- Using the velcro (9) stick the transceiver (6) on the top of the opener as shown.



WARNING: DO NOT drill into the chassis or covers. No screws are required to secure the transceiver.

Re-setup and Test the Opener

- Reconnect power and remove the button cover.
- Setting Limits:
 - If limits have not been set, follow the openers installation sheet to set limits.
 - If limits were set previously, clear limits and follow openers installation sheet to set limits.
- Refer to the Smart Phone Control Kit User Guide to set up network capabilities.

Warranty and Exclusion of Liability



REGISTER ONLINE TODAY!

Register your Product to take advantage of convenient service and support at www.ata-aust.com.au/register

This Warranty is given by Automatic Technology (Australia) Pty Ltd (ABN 11 007 125 368) (ATA), 6-8 Fiveways Boulevard, Keysborough 3173, 1300 769 850, sales@ata-aust.com.au.

PLEASE NOTE:

- This Warranty is in addition to any statutory, non-excludable guarantees or warranty rights and remedies under the law. See section 5 below.
- This warranty applies to the original purchaser only and may not be transferred.
- This Warranty is to be read in conjunction with the owner's copy of the installation instruction manual.
- In this warranty, 'ATA Representative' means an entity authorized by ATA to service ATA products. Please check the ATA website for details.



It is a condition of the below warranties that the manual operating (opening and closing) force of the door by hand does not exceed 20kg.

MODEL	WARRANTY	DOOR (MAX)
SECTIONAL		
GDO-9V2	7 yrs / 20,000 cycles	200kg
GDO-9V3	7 yrs / 20,000 cycles	175kg
GDO-11V3	5 yrs / 10,000 cycles	110kg
ROLLING		
GDO-6V3	5 yrs / 10,000 cycles	110kg
GDO-6V4	7 yrs / 20,000 cycles	110kg
GDO-8V3	2 yrs / 5,000 cycles	100kg
GDO-10V3	2 yrs / 5,000 cycles	270kg
EXTRAS		
TRACK ASSEMBLY (includes all parts)	1 year	
TRANSMITTERS & ACCESSORIES	1 year	

NOTE: CONSUMABLES (eg Batteries in remote control transmitters and light bulbs and fuses) are not covered by this warranty

1. MAKING A CLAIM

- The product parts in the above table should operate in accordance with the product manual for the time period shown, provided you comply with the manufacturer's instructions concerning installation, operation, maintenance and testing. Failure to do so may void all or part of this warranty.
- If, during the relevant warranty period, a product part in the table above appears to contain a defect, call the retailer from whom you purchased the product, or ATA on 03 9791 0240, and they will instruct you what to do next.
- You are responsible for the cost of making a claim under this Warranty. Additional access expenses where the Product is not readily accessible must be borne by you.
- If ATA or ATA's Representative confirms the product is defective and covered by this Warranty, ATA will repair or replace it (at ATA's sole option) at no cost to you. Goods presented for repair may be replaced or repaired by refurbished goods or parts of the same type.

2. WARRANTY CONDITIONS

It is a condition of this warranty that:

- you provide a copy of the receipt of original purchase of the product, and the serial number of the Product which can be found on the label adhered to the Product.
- the Product has been serviced by ATA or an ATA Representative, within 12 months of installation (to allow for the door to settle) and at regular intervals not exceeding 2 years.

3. WARRANTY EXCLUSIONS

This warranty excludes defects or improper operation resulting from:

- excessive wear and tear that may cause the product to fail;
- accidental, deliberate or negligent damage or damage caused by insects, dirt, plants or other objects;
- blown fuses, electrical surges, power surges or power spikes or faulty or unsuitable electrical wiring of structures to which the product is affixed;
- theft, fire, flood, rain, water, lightning, storms or any other acts of God;
- salt or other corrosion due to environmental conditions;
- any installation, configuration or use of the product contrary to the instructions supplied with the product;
- maximum continuous operating time exceeding 1 minute in 10 minutes;
- the manual operating (opening and closing) force of the door by hand exceeding 20kg;
- weight exceeding amounts listed in table above;
- the door used with the product not being in safe working order and condition;
- any modification to the product or acts of any person in respect of the product which are not authorized by ATA;
- installation of a residential garage door opener in a commercial or industrial premises or in a dwelling other than a single-family dwelling; or
- radio or electrical interference or lack of availability of signal.

4. OTHER CONDITIONS

- This Warranty is not transferable.
- The warranty period stated in the table will not be extended for Products or parts repaired or replaced during the relevant warranty period.
- Where the Product is sold by any person other than ATA, except for the warranty set out above, such person has no authority from ATA to give any warranty or guarantee on ATA's behalf in addition to the warranty set out above.

5. STATUTORY GUARANTEES OR WARRANTIES IN AUSTRALIA

If you are a consumer under the Australian Consumer Law, our goods come with guarantees that cannot be excluded under the Australian Consumer Law. You are entitled to a replacement or refund for a major failure and for compensation for any other reasonably foreseeable loss or damage. You are also entitled to have the goods repaired or replaced if the goods fail to be of acceptable quality and the failure does not amount to a major failure.

This warranty certificate and other statements contained in this document or other ATA documents given to you do not exclude, restrict or modify the application of all or any of the provisions of the Australian Consumer Law.

Subject to your non-excludable rights under the Australian Consumer Law, ATA expressly excludes any liability for consequential loss, incidental or indirect damages (including but not limited to damages for loss of business profits, business interruption and loss of business information) due to a defect of the Product. In particular, any loss or damage caused to other equipment or accessories used with the product or any loss resulting from a delay in repair is excluded to the extent permitted by law.